

带CAP示意图

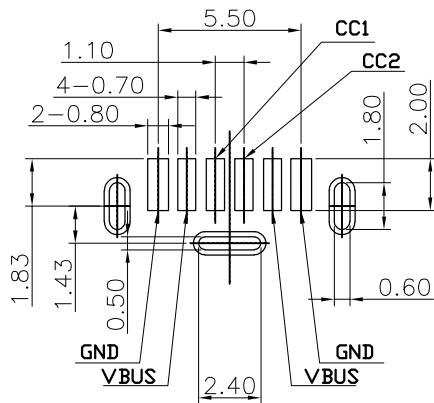

RECOMMEND P.C.B LAYOUT (COMPONENT SIDE)
TOLERANCE FOR PCB LAYOUT IS ± 0.05

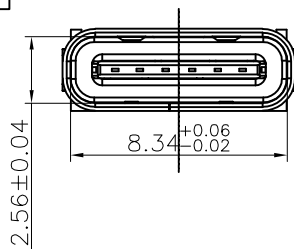
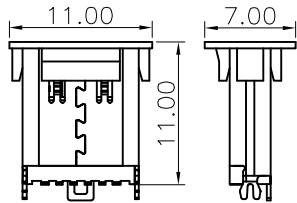
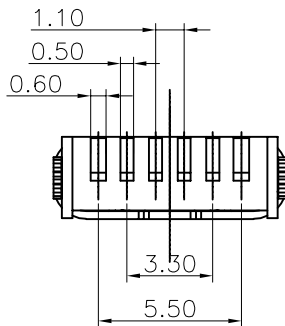
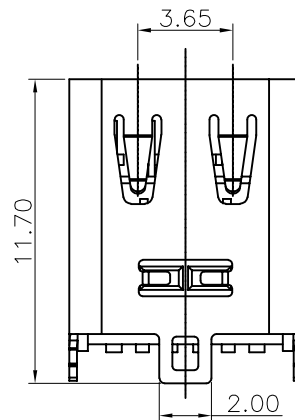
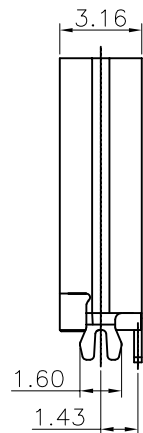
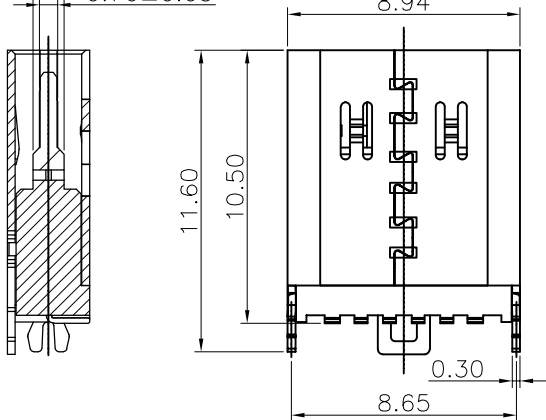
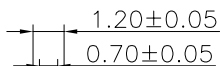

B12	GND
B9	VBUS
B5	CC2
A5	CC1
A9	VBUS
A12	GND
PIN	SIGNAL NAME

尺寸	允许公差
x.	±0.50
.x	±0.20
.xx	±0.15
.xxx	±0.10
角度	±1.00°

深圳市创勤科技有限公司
SHENZHEN CHUANGQIN TECHNOLOGY CO., LTD.

图纸类型

图纸名称:

产品工程图

6Pin-TYPE C-L10.5立贴

设计 LIN YUN 2019.05.08

产品料号 CQ045-TFLT0606803

审核 ZHANG 2019.05.08

视图

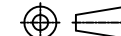

版号: A

NOTES:

1.MATERIAL:

MOLDING: LCP UL94 V-0
CONTACT: COPPER ALLOY.
GOLD PLATED ON CONTACT AREA,
NICKEL PLATING OVER ALL.
SHELL: SUS304-H,T=0.30±0.03mm
30u" NICKEL PLATING OVER ALL.

2.MECHANICAL:

INSERTION: 5~20N.
EXTRACTION: 8~20N AFTER TEST.

3.ELECTRICAL:

CURRENT: 5A FOR VBUS;
1.25A FOR GND PIN.
0.25A FOR OTHER.

VOLTAGE: 20 V MAX

WITHSTANDING VOLTAGE: 100V AC R.M.S.
CONTACT RESISTANCE: 40mΩ MAX.
INSULATION RESISTANCE: 100MΩ MIN.

4.ENVIRONMENTAL

TEMPERATURE RANGE -25°C ~ +85°C

5. 尺寸标注事项:

图示有标示"⊗"者为首样全检, 重点管控尺寸.

6. 产品符合RoHS标准

